



WOODSIDE PARK AMENDED FACILITY PLAN COMMUNITY MEETING

JUNE 8, 2021





MEETING LOGISTICS:

This presentation is being recorded and will be available to review after the meeting at :

<http://mcp-events.org/woodsidemtg>

And at the project web site:

<http://mcp-events.org/woodsideproject>



PROJECT INFORMATION:

PROJECT WEBSITE AND
OPEN TOWN HALL SURVEY:

<http://mcp-events.org/woodsideproject>

PROJECT MANAGER:

Christie Ciabotti

Christie.Ciabotti@MontgomeryParks.org

301-650-4365



AGENDA:

1. Existing Conditions
2. Facility Plan & Design History
3. Planning Guidance
4. Design Priorities & Park Program
5. Concept Plans
6. Next Steps
7. Discussion

PARK CONTEXT AND EXISTING CONDITIONS



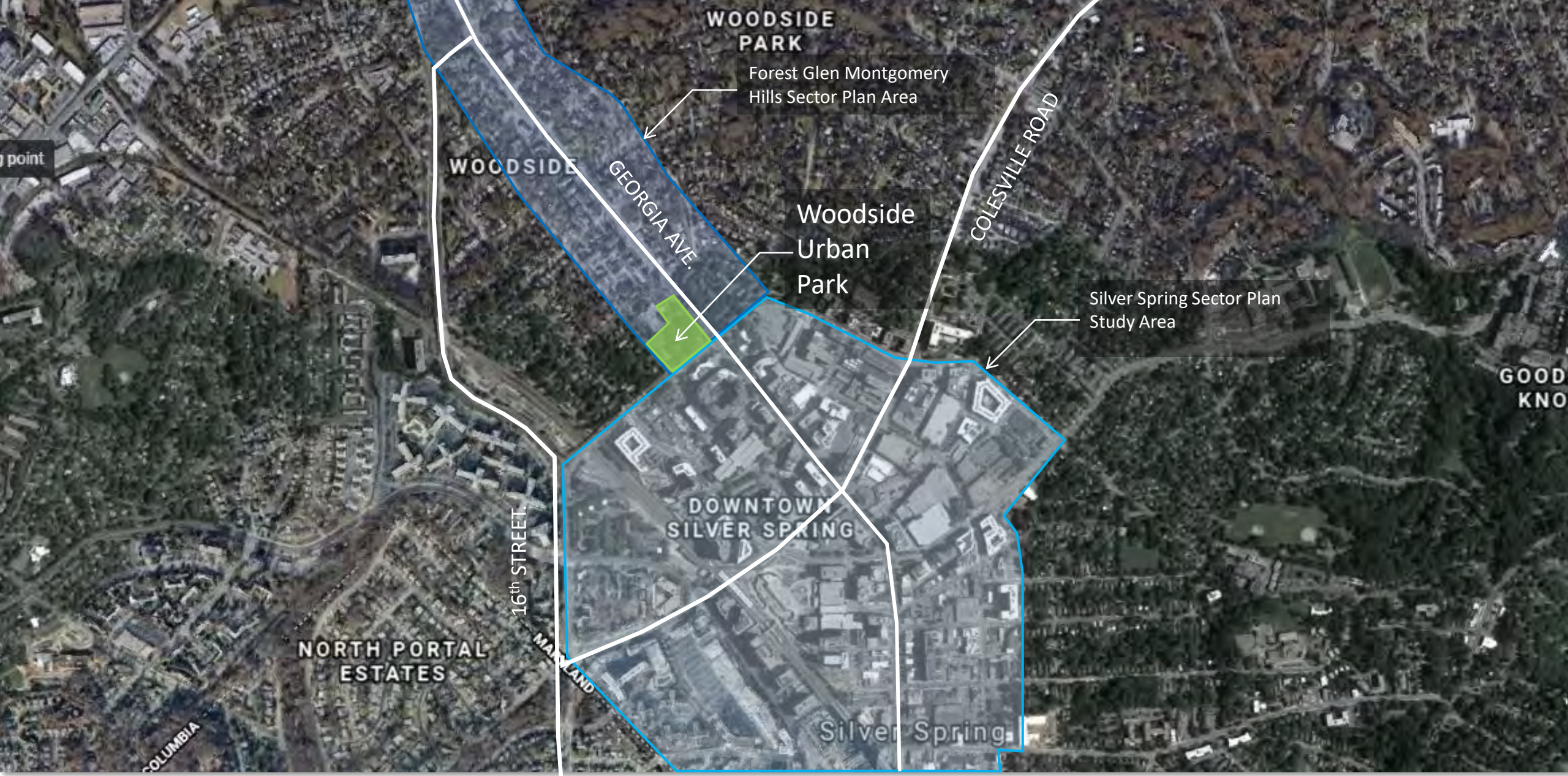

PARK CONTEXT- LOCATION

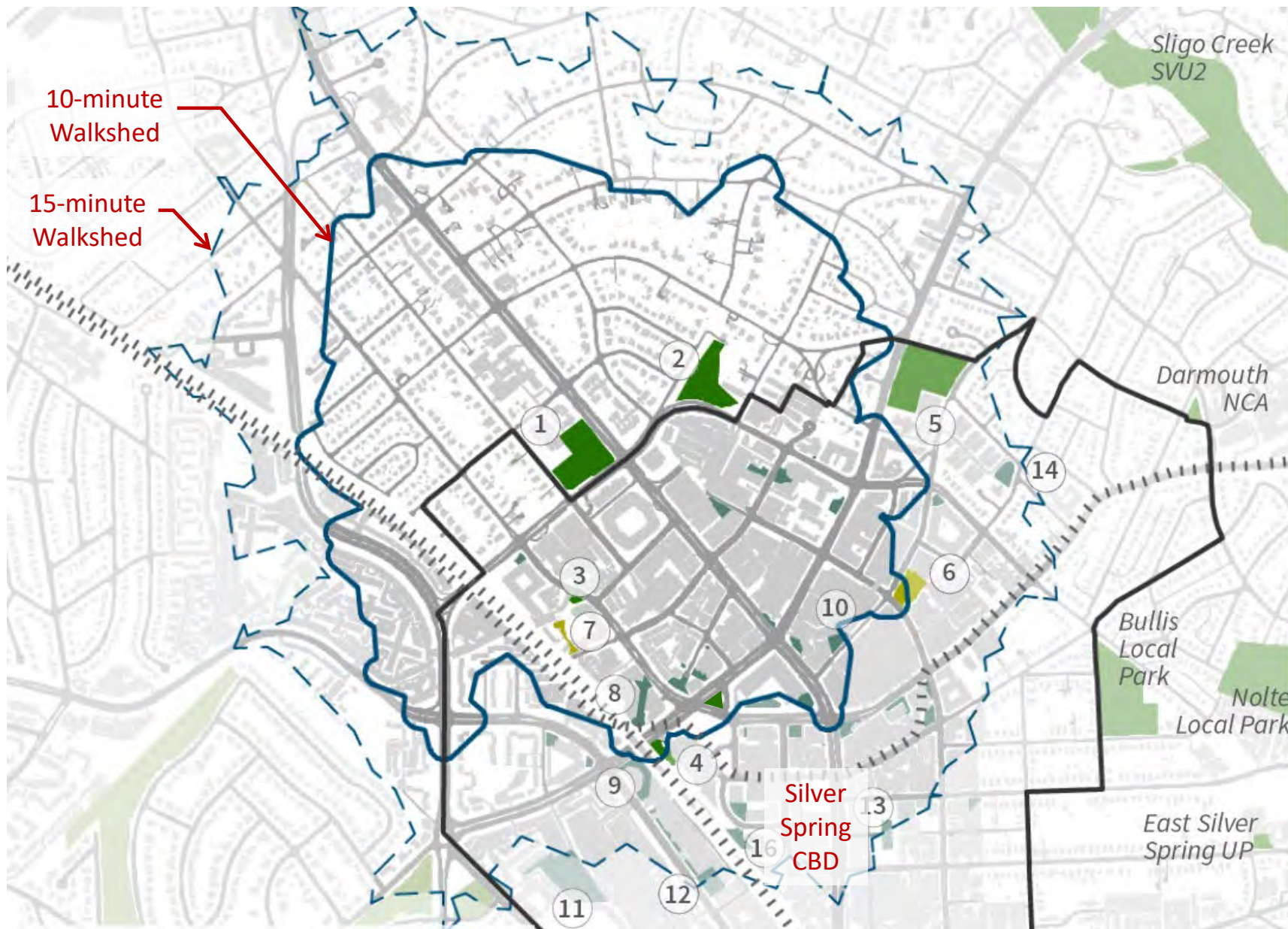

1. Woodside Urban Park
2. Fairview Urban Park
3. Kramer Urban park
4. Gene Lynch Urban Park and Silver Spring Transit Plaza Urban Park
5. Ellsworth Urban Park

PARK CONTEXT-NEARBY PARKS



EXISTING CONDITIONS- PARK BOUNDARY

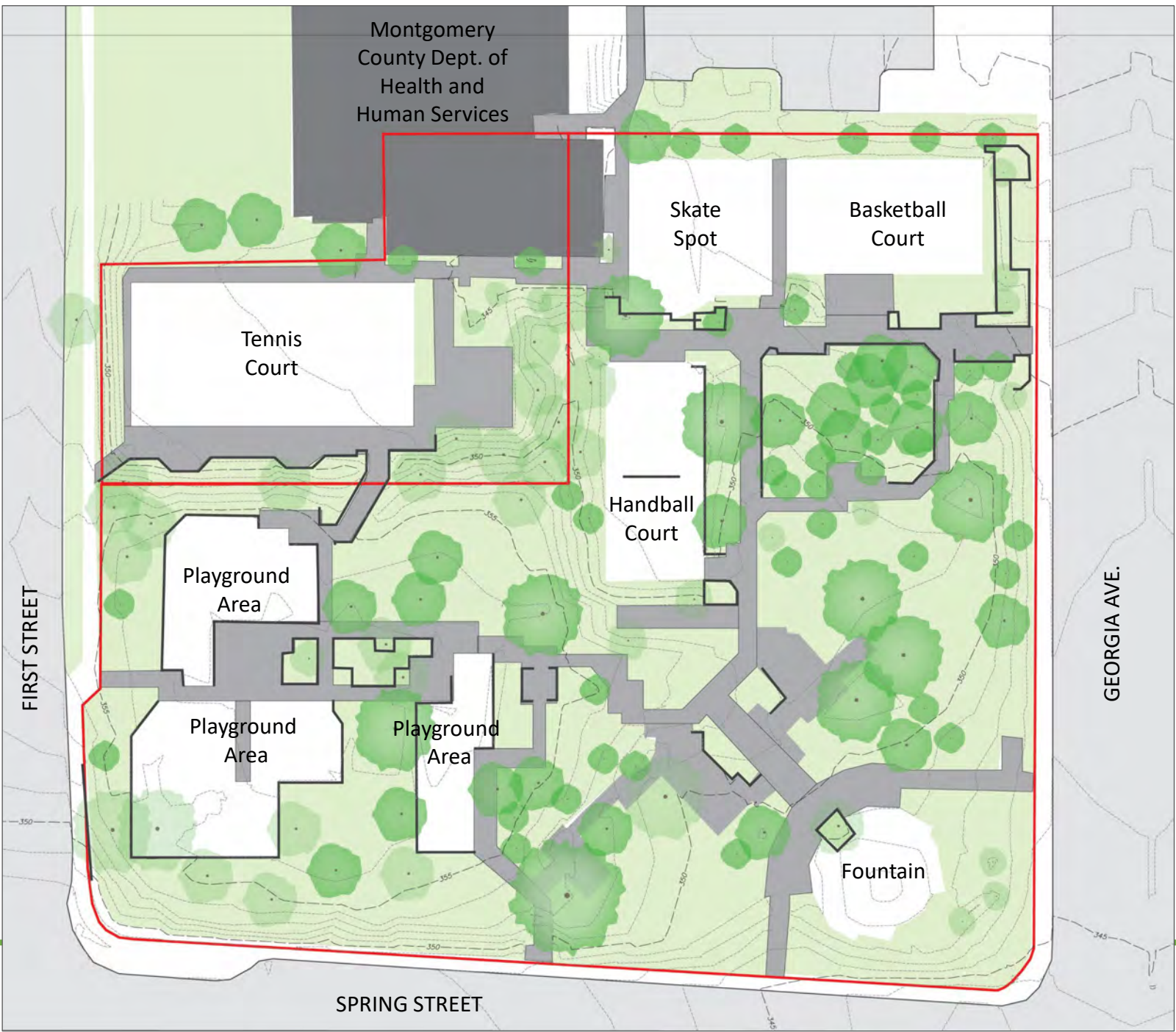

- 1. PARK ENTRANCES/SIDEWALKS**
- 2. CIRCULATION**
- 3. AMENITIES AND LIGHTING**
- 4. OPEN SPACE**
- 5. GRADE CHANGE**
- 6. TREES**
- 7. STORMWATER**

EXISTING CONDITIONS

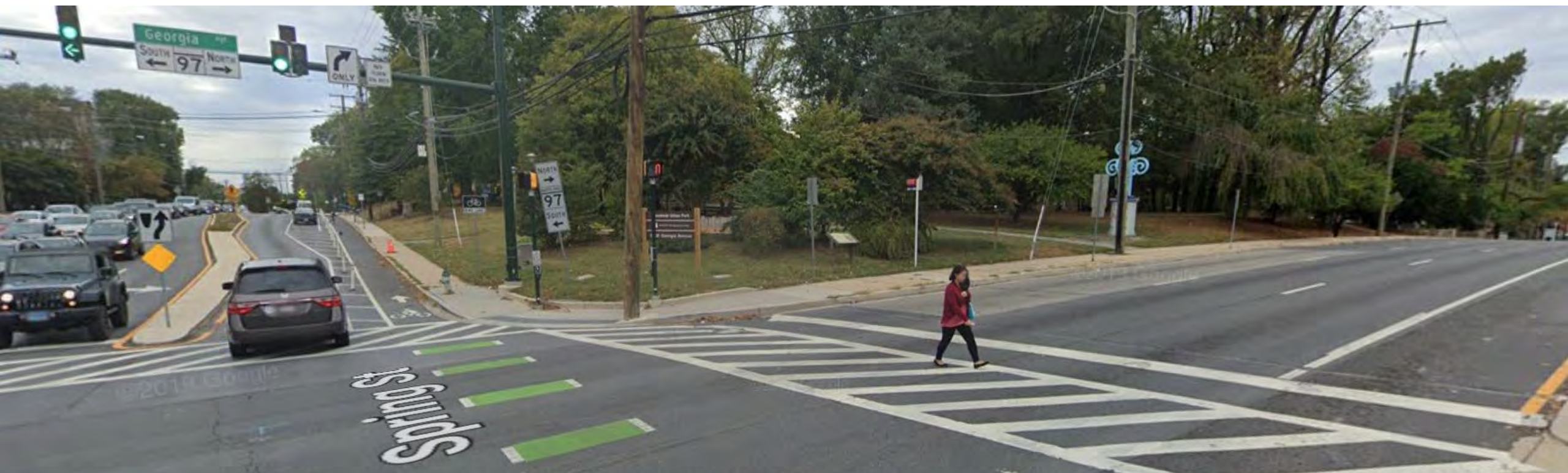

INTERSECTION– SPRING STREET AND GEORGIA



GEORGIA AVENUE



SPRING STREET



FIRST STREET



EXISTING CONDITIONS - PARK ENTRIES



EXISTING CONDITIONS - CIRCULATION



EXISTING CONDITIONS - AMENITIES



EXISTING CONDITIONS - FOUNTAIN



EXISTING CONDITIONS - PLAYGROUND



EXISTING CONDITIONS – OPEN SPACE AND GRADE CHANGE

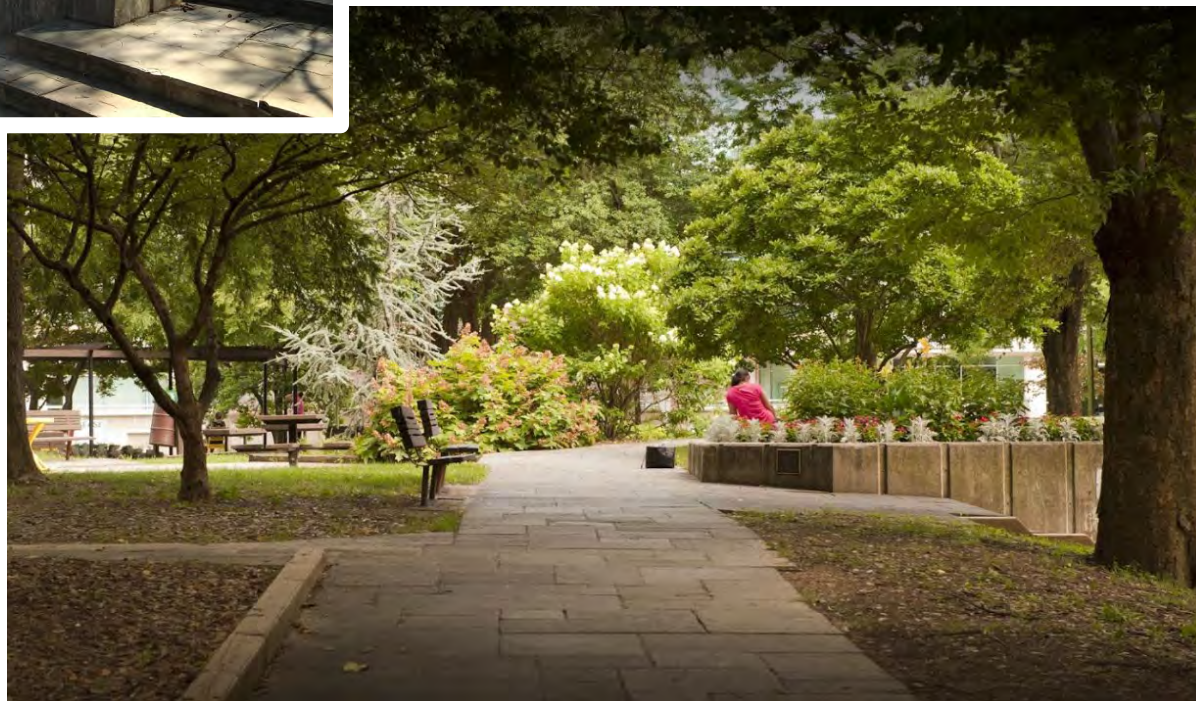

EXISTING CONDITIONS - TREES

2009-2017
FACILITY PLAN
AND
DESIGN HISTORY





2011 FACILITY PLAN

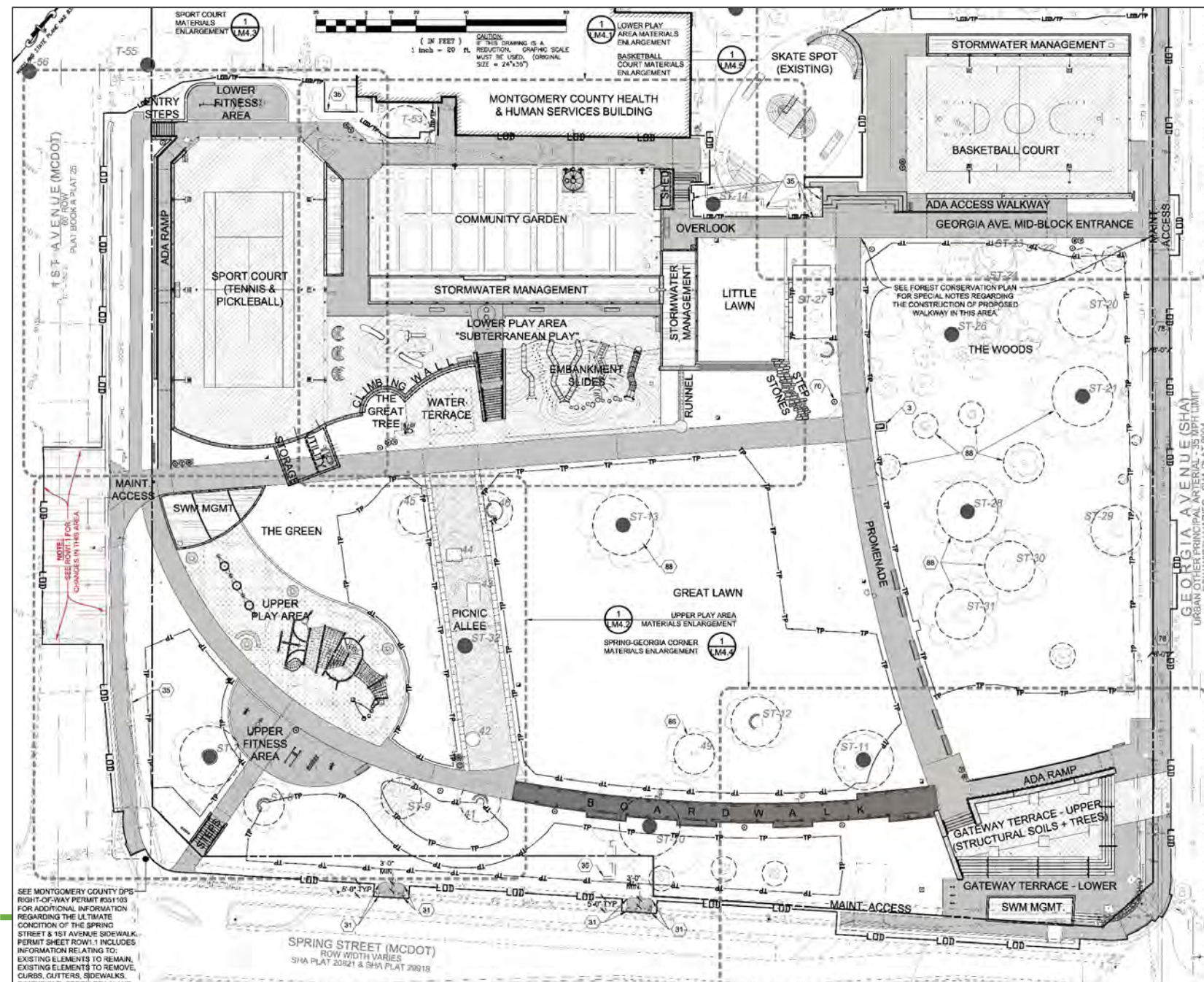

2017 CONSTRUCTION DOCUMENTATION

Revised Budget

- Original Budget \$6.99M
- New Budget - Park Refresher: \$3M Budget

Technical Documentation and Research:

- Extensive technical documentation including survey, tree root investigation, soil borings, drainage maps
- Grading studies/cut fill studies
- Critical root zone studies
- Tree preservation techniques/details



OUTCOME

PLANNING DOCUMENTATION AND GUIDANCE



Energized Public Spaces Functional Master Plan (EPS) – 2018
Designing Public Spaces - EPS Design Guidelines – 2019

Park Recreation and Open Space Plan (PROS) – 2017

Forest Glen/Montgomery Hills Sector Plan - 2020

Silver Spring Streetscape Standards – 2020

Silver Spring CBD Sector Plan – 2000

North and West Silver Spring Master Plan – 2000

Bicycle Master Plan – 2018

Thrive Montgomery 2050 – Draft



RELEVANT PLANNING DOCUMENTS

Woodside Park as **URBAN RECREATIONAL PARK**

A New Park Classification System

Urban Recreational Park:

Oriented to the recreational needs of a densely populated neighborhood and business district. They provide space for many activities.

May include athletic fields, playing courts, picnicking, dog parks, sitting areas and flexible grassy open space.

Main Program

- Recreational program focused on active recreation
- Supported by contemplative setting and social gathering spaces
- Activities to accommodate all age groups

Key Features

- Playing courts and fields
- Mix of hardscape and grassy open spaces
- Mix of reserved and unreserved recreation spaces
- Central lawn as focal point
- Multi-functional structures and park furniture

- **Gateway Park:**

Woodside is important gateway park for both Silver Spring CBD and Montgomery Hills Sector Plans

- **Multi-faceted Urban Park:**

Serves Silver Spring CBD and adjacent residential neighborhoods

- **Increasing Demand:**

New mixed-use developments will increase demand for open space and park amenities. Population majority adult.

- **Successful Park Needs Strategic Improvements:**

Improvement needed to meet growing demand for active recreation and multi-generational activities

RECOMMENDATIONS

- Expand skate spot
- Repurpose tennis court to multi-use court
- Repurpose handball court
- Add multi-generational play/activity areas
- Improve ADA accessibility
- Add walking loop
- Add unprogrammed open space
- Incorporate art in the park
- Improve lighting
- Remove fountain

DESIGN PRIORITIES AND PARK PROGRAM



MEET CURRENT BUDGET (\$2-2.5M Construction Cost)

- work with existing park features
- minimize earthwork
- use materials creatively and efficiently
- prioritize proposed changes and check costs frequently

IMPROVE INFRASTRUCTURE

- remove existing outdated fountain
- include stormwater management
- create accessible routes
- preserve signature tree canopy
- improve access for park maintenance

REIMAGINE CIRCULATION

- highlight entry at Georgia and Spring
- improve visibility/accessibility of park entries
- simplify complicated path network
- reduce steps and pathway grade changes

IMPROVE SAFETY

- provide improved visibility to secluded areas
- improve park lighting



ENHANCE THE FUN STUFF

- expand skate spot
- add multi-generational play/fitness elements
- improve playground areas
- repurpose tennis court for multi sport
- repurpose handball court
- create flexible open space
- incorporate public art

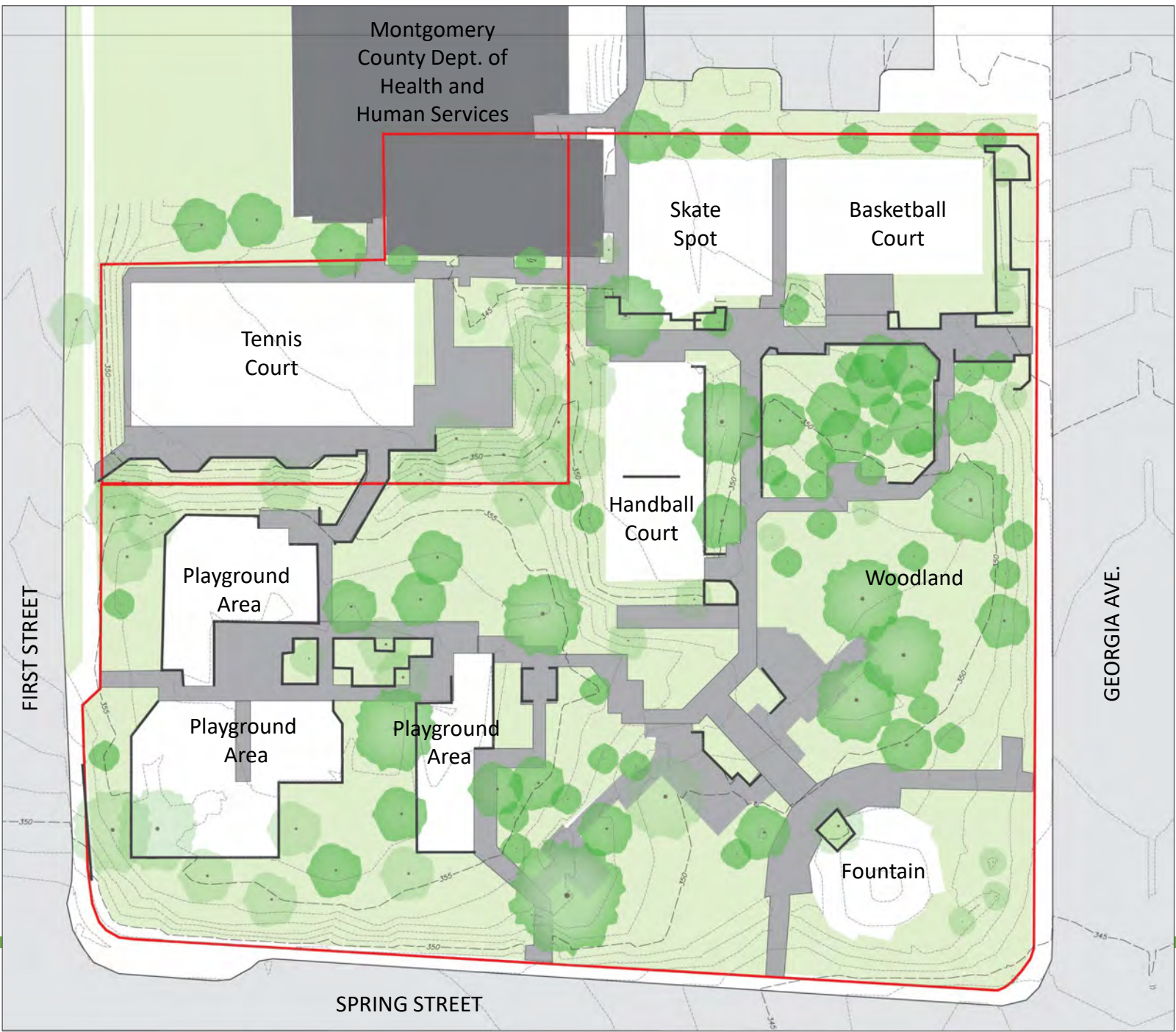

EXISTING CONDITIONS

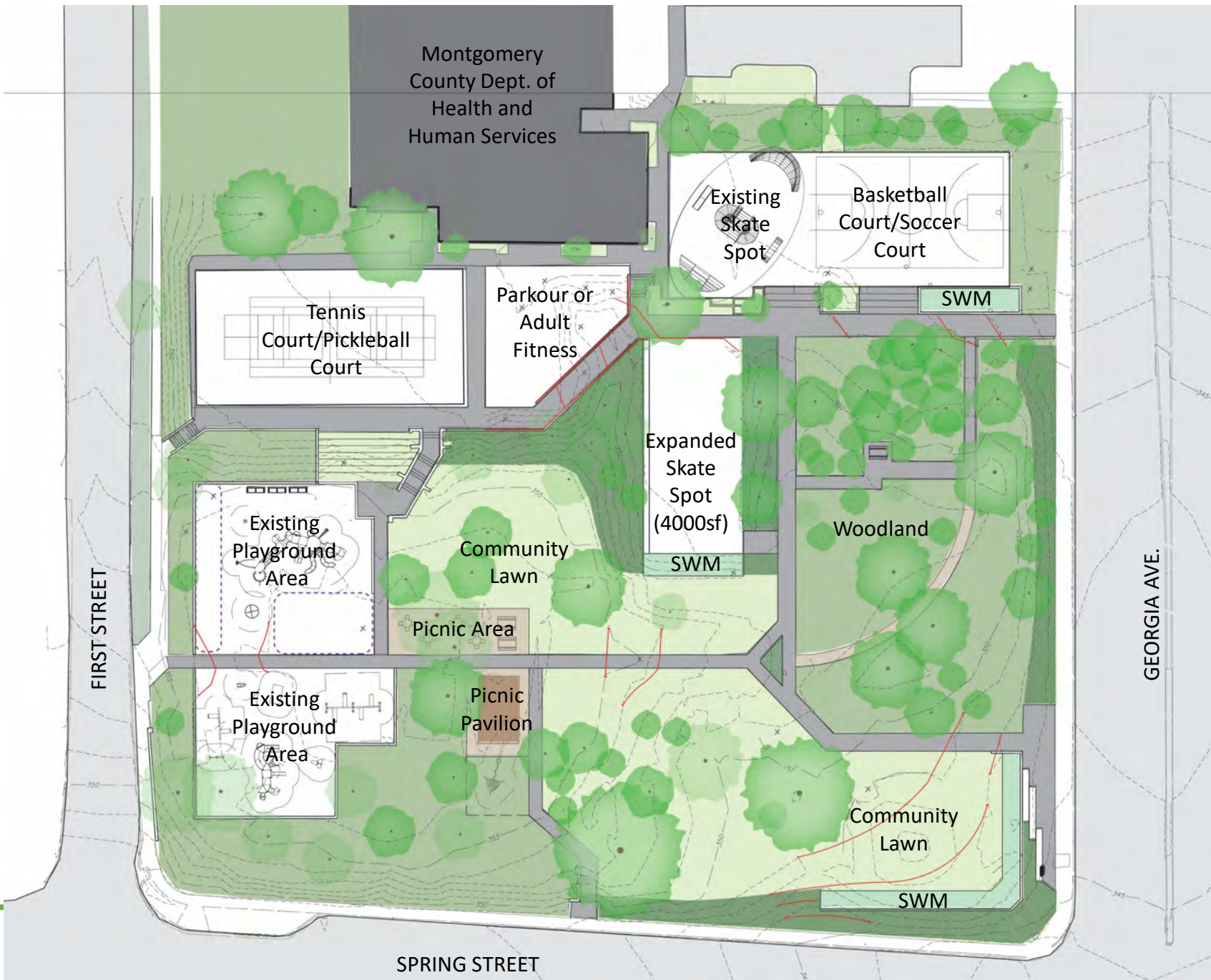

CONCEPT 1

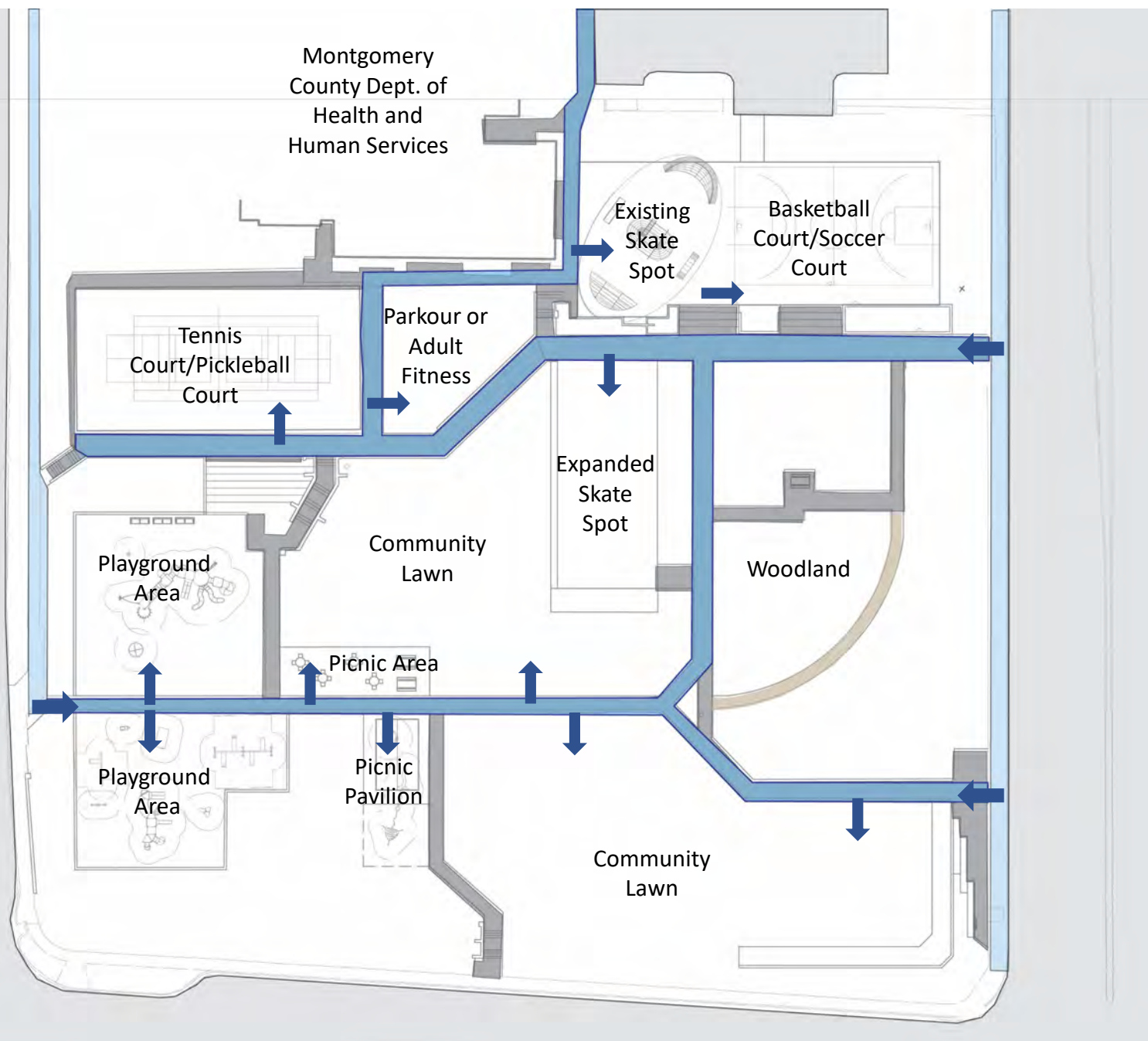

CONCEPT 1
Accessible Routes

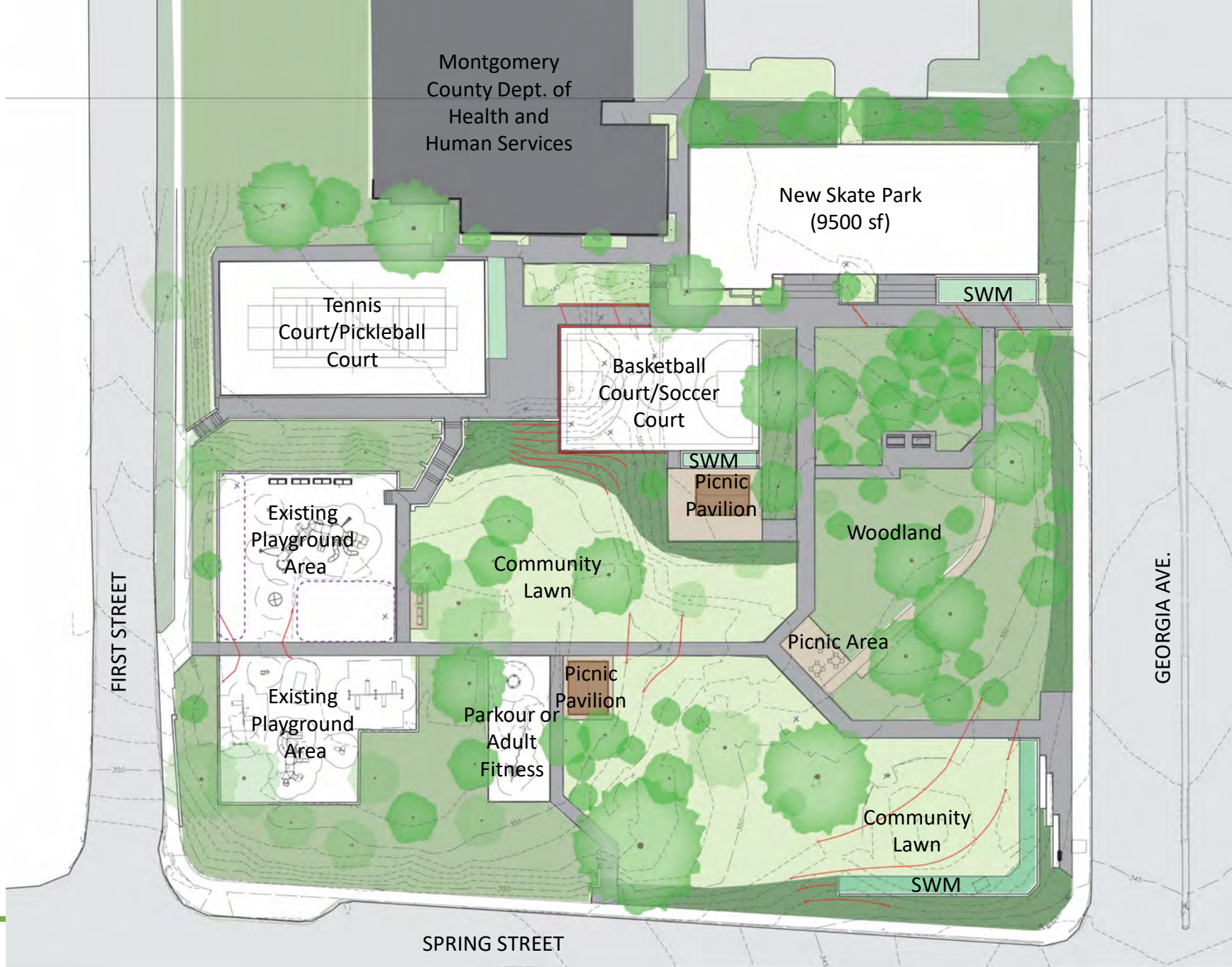

CONCEPT 2

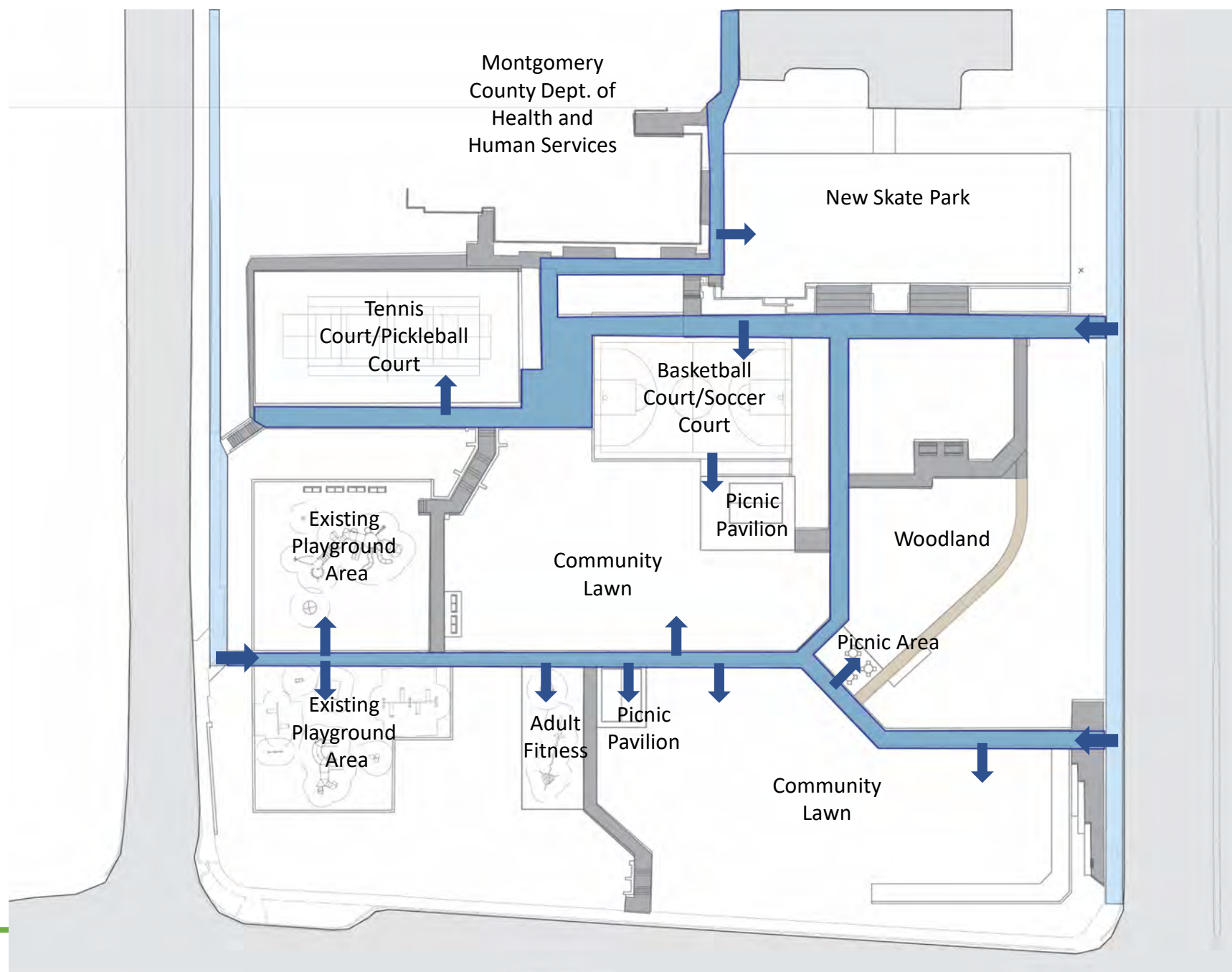

CONCEPT 2
Accessible Routes

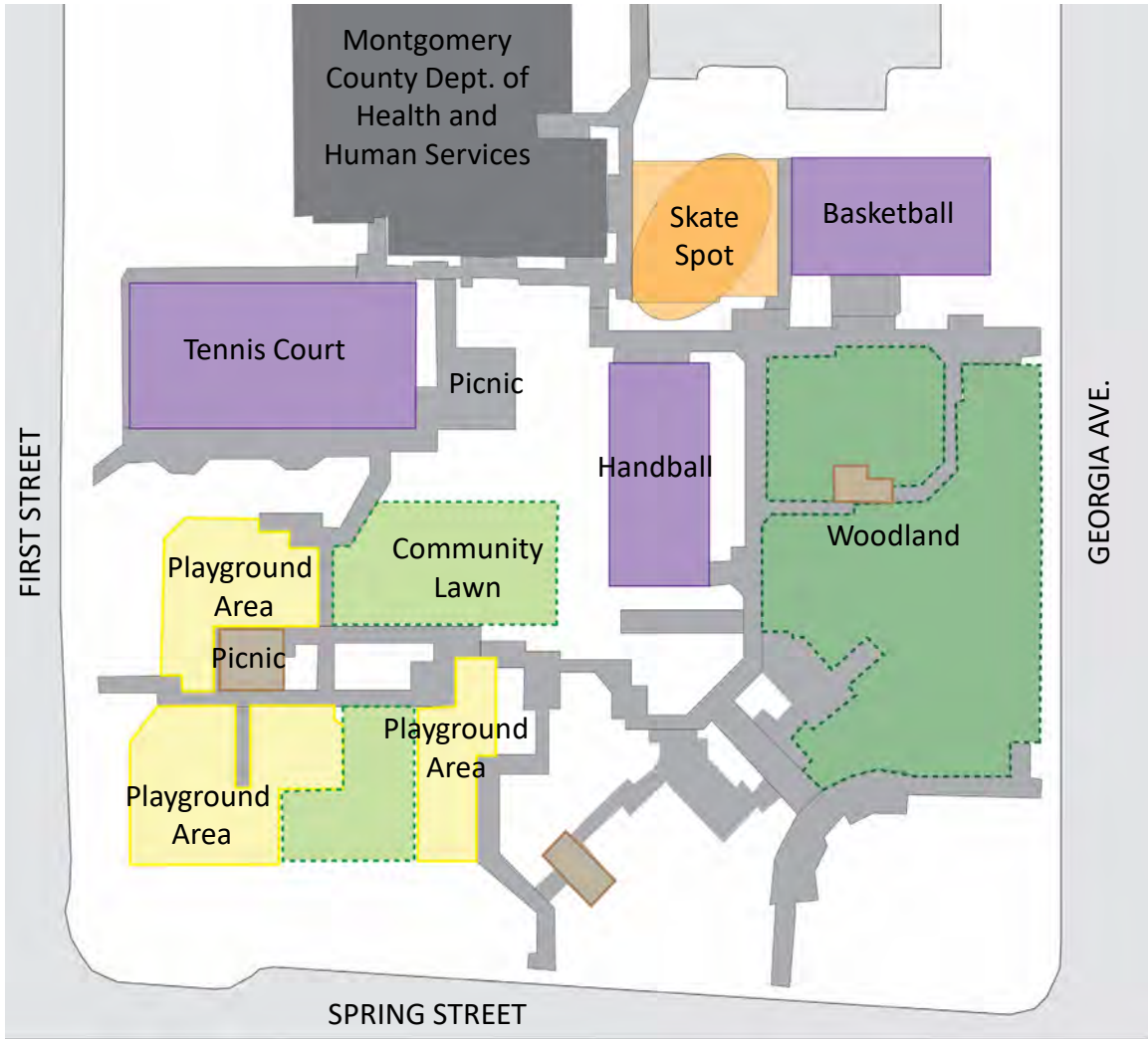

EXISTING CONDITIONS

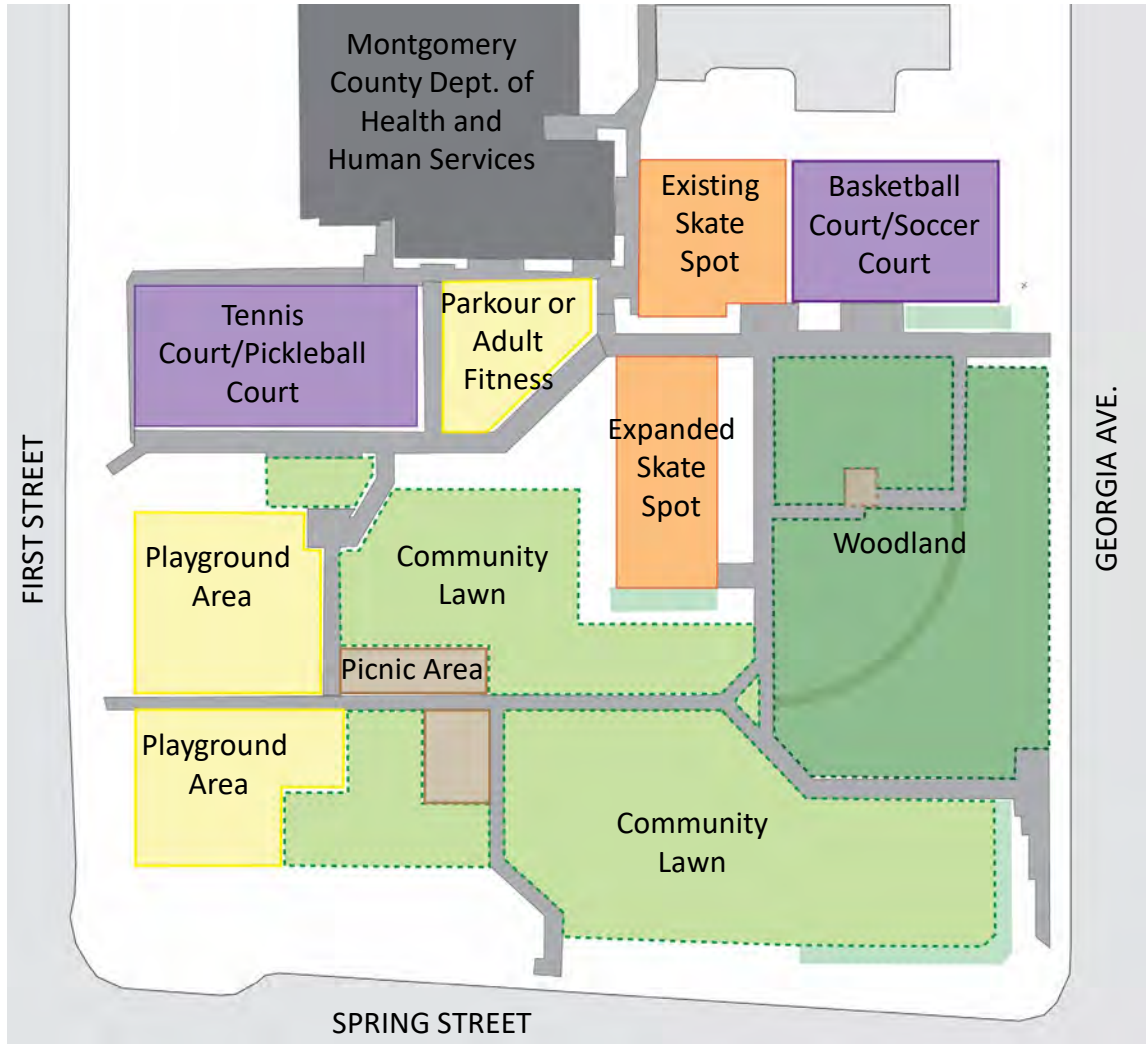

OPTION 1

USE DIAGRAM OPTION 1

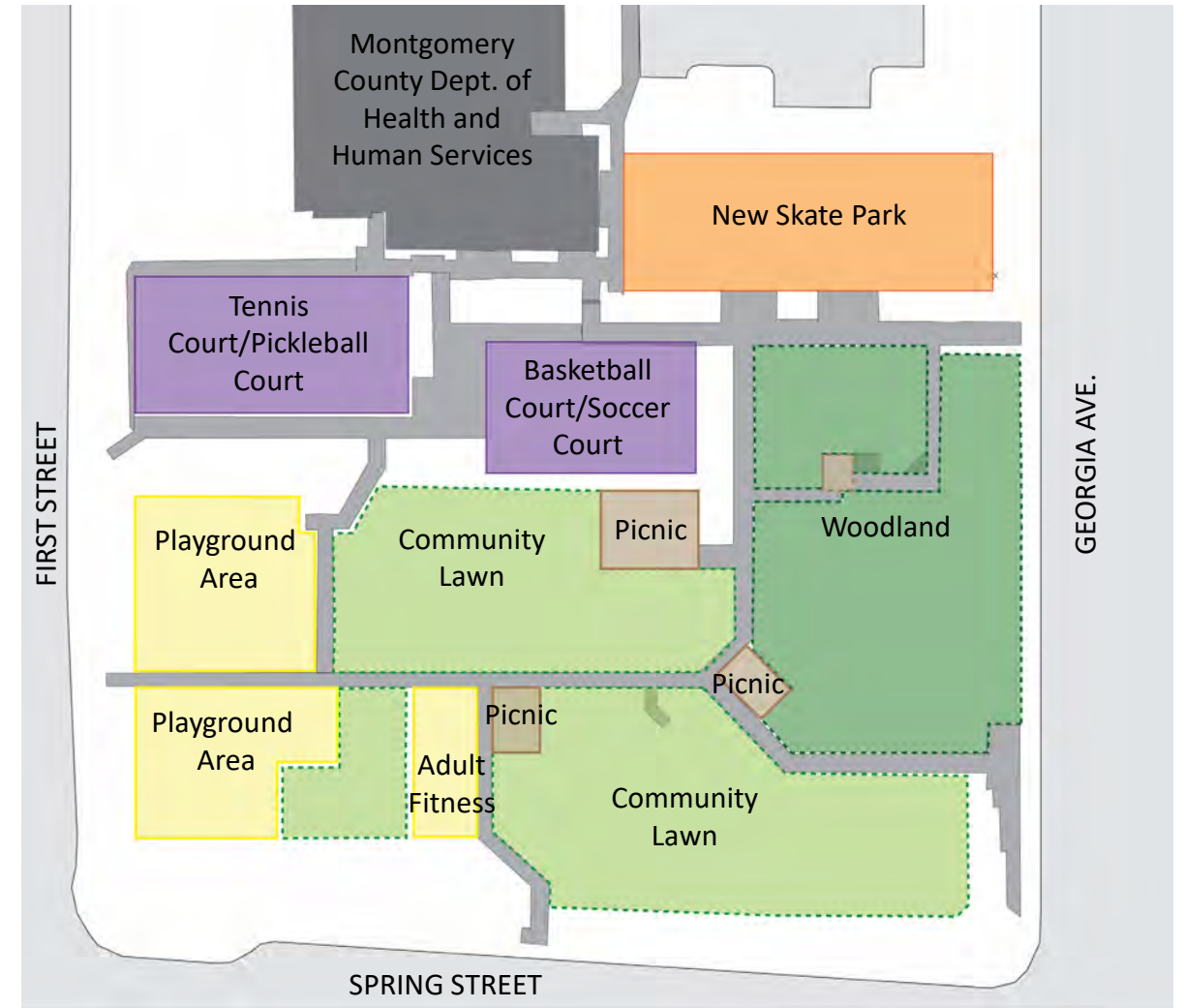
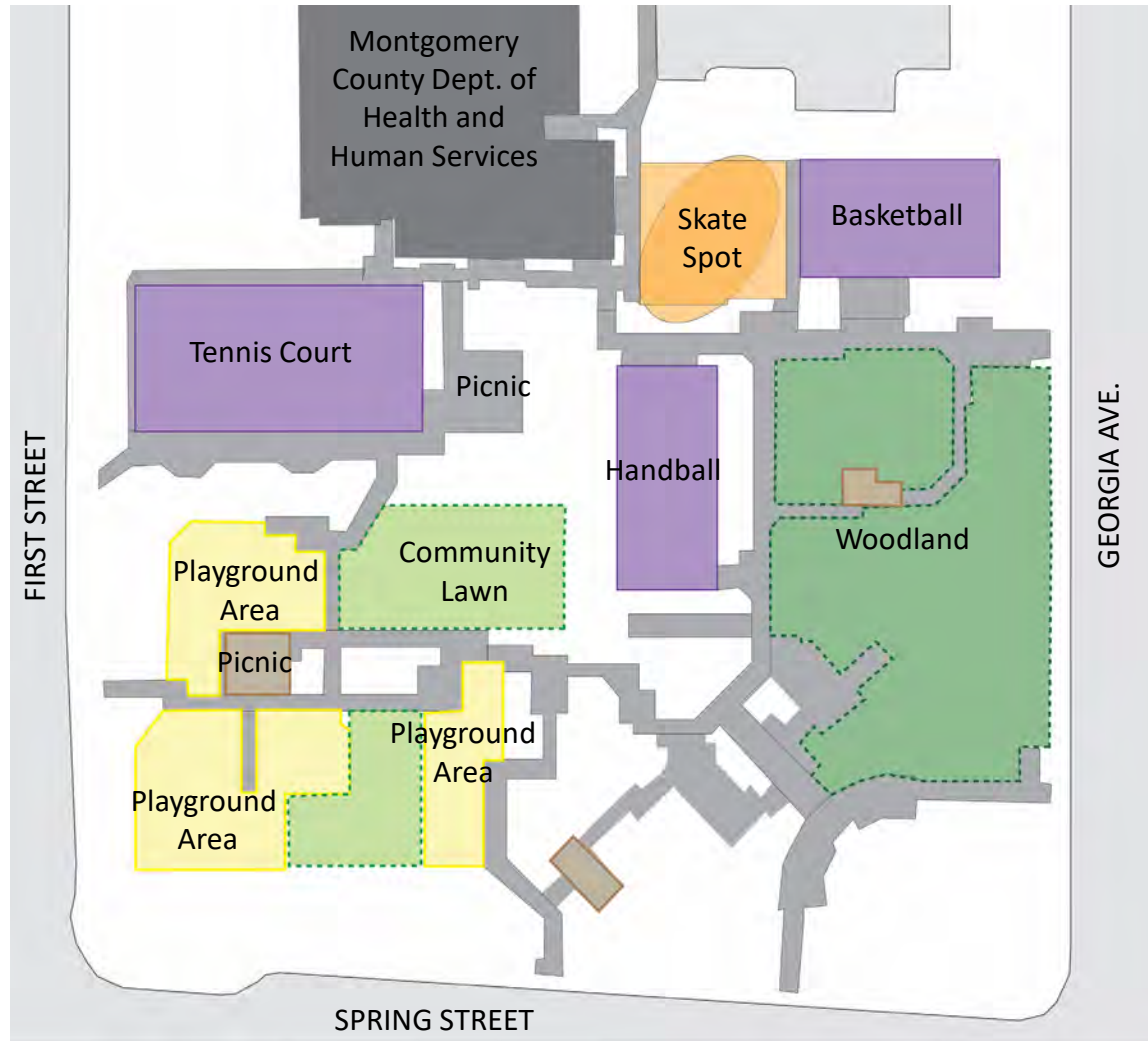

USE DIAGRAM-OPTION 2



COMMUNITY LAWN



MULTI GENERATIONAL PLAY/FITNESS



SPORT COURTS



ENHANCE EXISTING SKATE SPOT



THE JUGGLER – RESTORED AND IN STORAGE

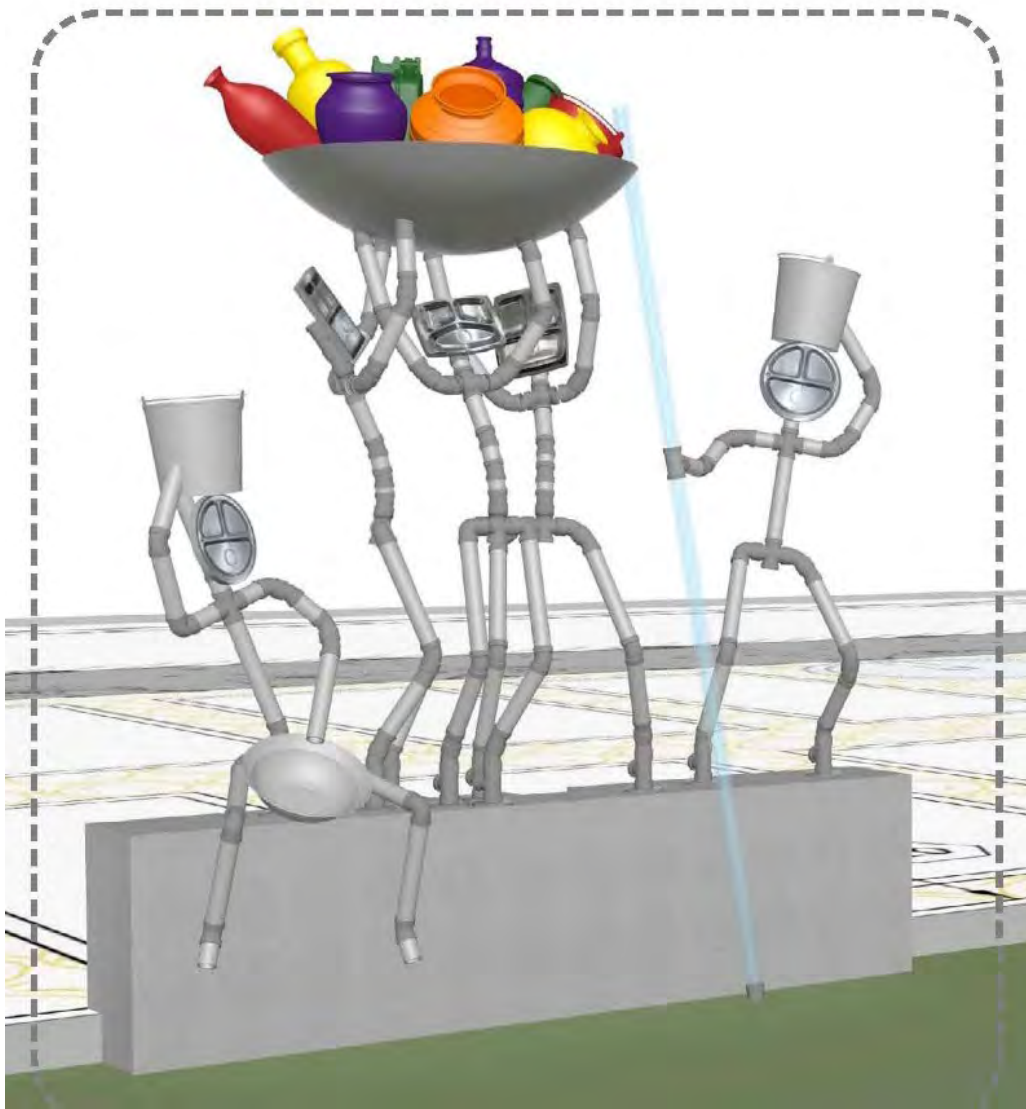

ENVIRONMENTAL ARTWORK IN PROGRESS



PUBLIC ART

NEXT STEPS and ESTIMATED TIMELINE

- Amended Facility Plan to Planning Board for Approval
-Early 2022
- Detailed Design and Permitting
-2022-2023
- Construction
-2023-2024



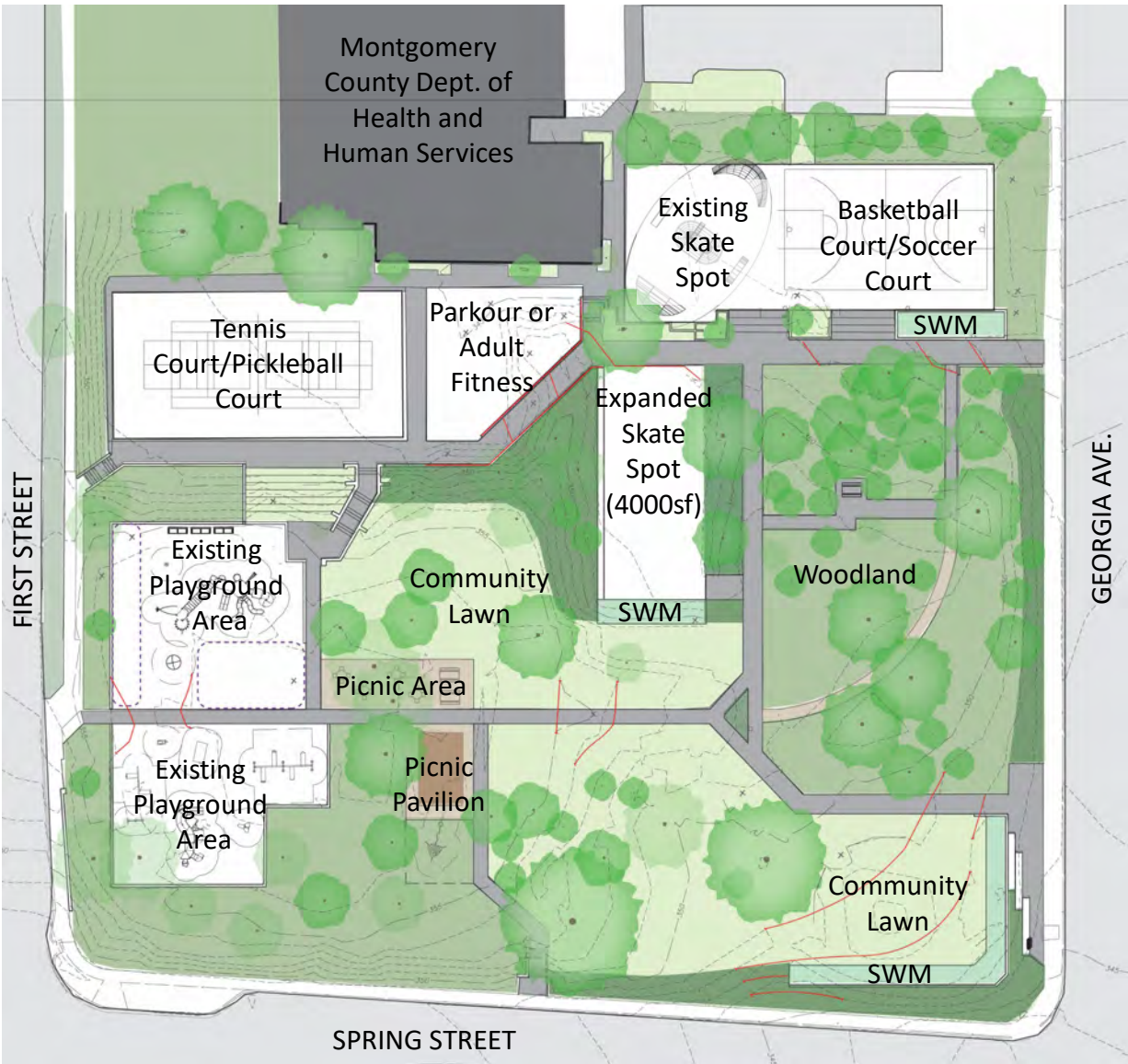

CONCEPT 1

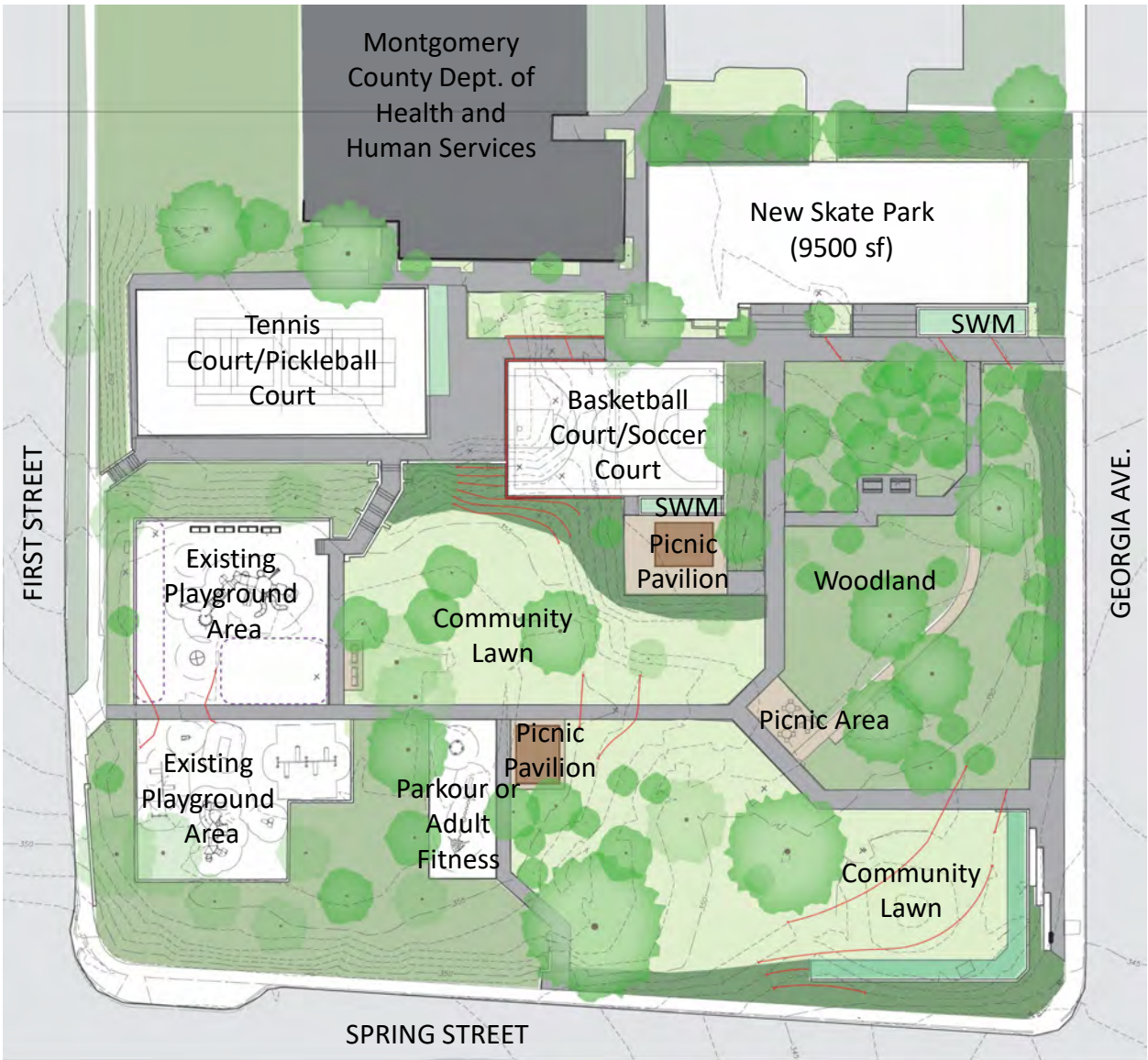

CONCEPT 2

QUESTION AND ANSWER DISCUSSION

THANK YOU!

- PROJECT WEBSITE AND
OPEN TOWN HALL SURVEY:
<http://mcp-events.org/woodsideproject>
- PROJECT MANAGER:
Christie Ciabotti
Christie.Ciabotti@MontgomeryParks.org
301-650-4365



